

UPLIGHT

Clip BF



UPLIGHT Clip

DE	Aufbau- & Bedienungsanleitung: Intelligente Büroleuchte, Tischplattenbefestigung UPLIGHT Clip BF	Seite 2
EN	Assembly- and User Manual: Intelligent office light for table top mounting UPLIGHT Clip BF	Page 4
IT	Istruzioni di montaggio ed utilizzo: Lampada da ufficio intelligente con montaggio al piano UPLIGHT Clip BF	Pagina 6

UPLIGHT CLIP

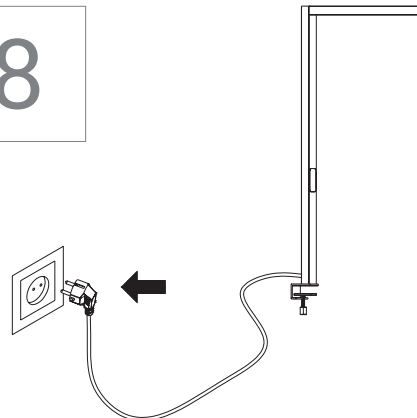
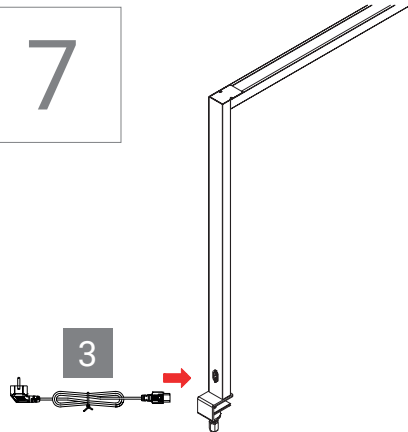
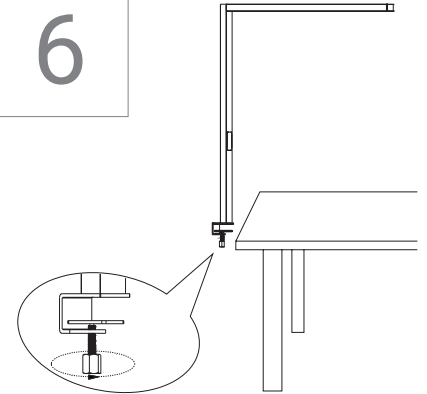
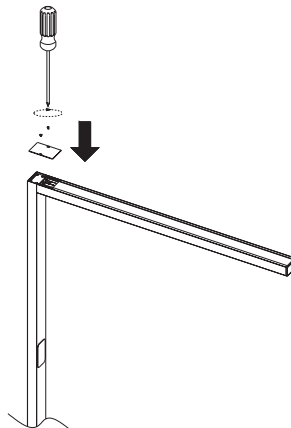
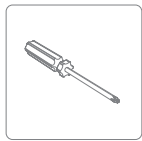
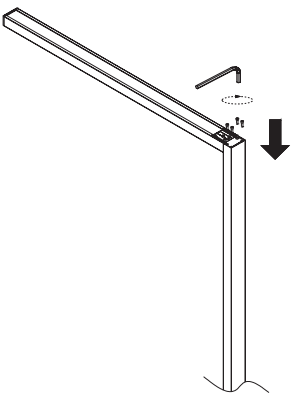
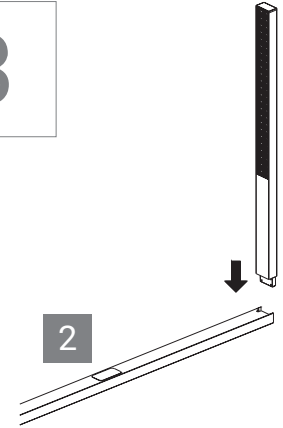
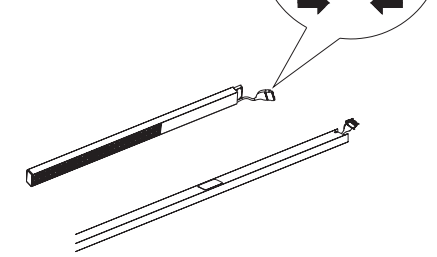
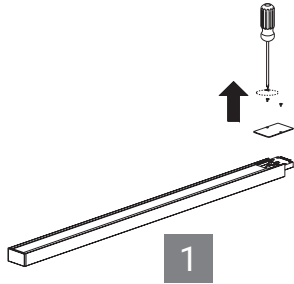
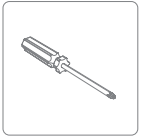
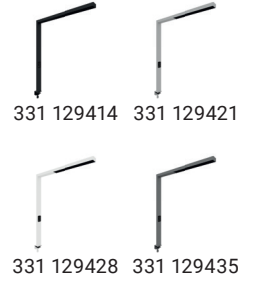
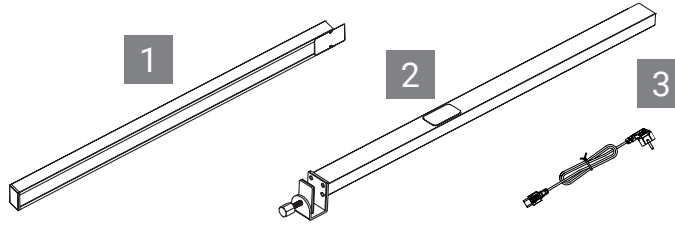
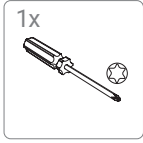
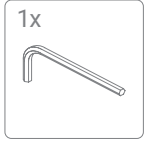
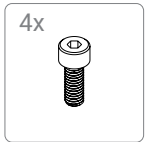

Korrekte Entsorgung

Das Symbol des durchgestrichenen Müllimers besagt, dass dieses Elektro- bzw. Elektronikgerät am Ende seiner Lebensdauer nicht im Hausmüll entsorgt werden darf, sondern vom Endnutzer einer getrennten Sammlung zugeführt werden muss. Zur Rückgabe stehen in Ihrer Nähe kostenfreie Sammelstellen für Elektroaltgeräte sowie ggf. weitere Annahmestellen für die Wiederverwendung der Geräte zur Verfügung. Die Adressen können Sie von Ihrer Stadt- bzw. Kommunalverwaltung erhalten.

Auch Vertrieber mit einer Verkaufsfläche für Elektro- und Elektronikgeräte von mindestens 400 Quadratmetern sowie Vertrieber von Lebensmitteln mit einer Gesamtverkaufsfläche von mindestens 800 Quadratmetern, die mehrmals im Kalenderjahr oder dauerhaft Elektro- und Elektronikgeräte anbieten und auf dem Markt bereitstellen, sind verpflichtet unentgeltlich alte Elektro- und Elektronikgeräte zurückzunehmen. Diese müssen bei der Abgabe eines neuen Elektro- oder Elektronikgerätes an einen Endnutzer ein Altgerät des Endnutzers der gleichen Geräteart, das im Wesentlichen die gleichen Funktionen wie das neue Gerät erfüllt, am Ort der Abgabe oder in unmittelbarer Nähe hierzu unentgeltlich zurückzunehmen sowie ohne Kauf eines Elektro- oder Elektronikgerätes auf Verlangen des Endnutzers bis zu drei Altgeräte pro Geräteart, die in keiner äußeren Abmessung größer als 25 Zentimeter sind, im Einzelhandelsgeschäft oder in unmittelbarer Nähe hierzu unentgeltlich zurückzunehmen. Bei einem Vertrieb unter Verwendung von Fernkommunikationsmitteln gelten als Verkaufsflächen des Vertriebers alle Lager- und Versandflächen.

Sofern das alte Elektro- bzw. Elektronikgerät personenbezogene Daten enthält, sind Sie selbst für deren Löschung verantwortlich, bevor Sie es zurückgeben. Sofern dies ohne Zerstörung des alten Elektro- oder Elektronikgerätes möglich ist, entnehmen Sie diesem bitte alte Batterien oder Akkus sowie Altlampen, bevor sie es zur Entsorgung zurückgeben, und führen diese einer separaten Sammlung zu. Weitere Informationen zum Elektroggesetz finden Sie auf www.elektroggesetz.de. (WEEE-Reg.-Nr. DE: 52242201)



Technische Daten

Eingangsspannung:	AC200-240V	Abstrahlwinkel	indirekt: 112° / direkt: 45°
Eingangsleistung:	60W	Farbtemperatur:	3000 K / 4000 K / 5000 K / 6000 K
Beleuchtungseffekt:	130 LM/W	Schutzart:	IP40
Lichtstärke:	5500 lm direkt / 2300 lm indirekt	Arbeitstemp.:	-20°C~40°C
Beleuchtungsverhältnis:	70% indirekt / 30% direkt	Lebensdauer:	36000 Stunden
UGR	<6		

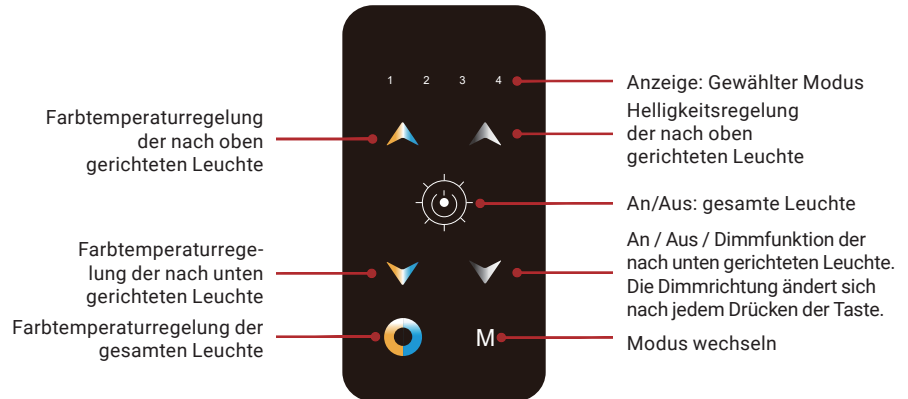
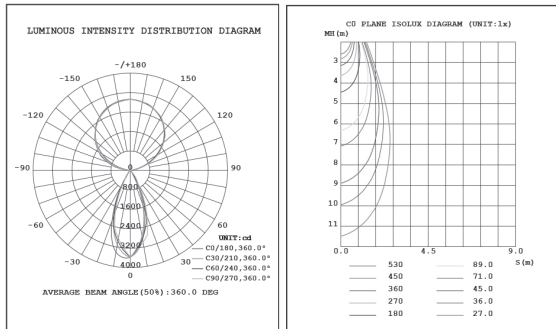

MODUS 1: Manuelle Bedienfeldregelung

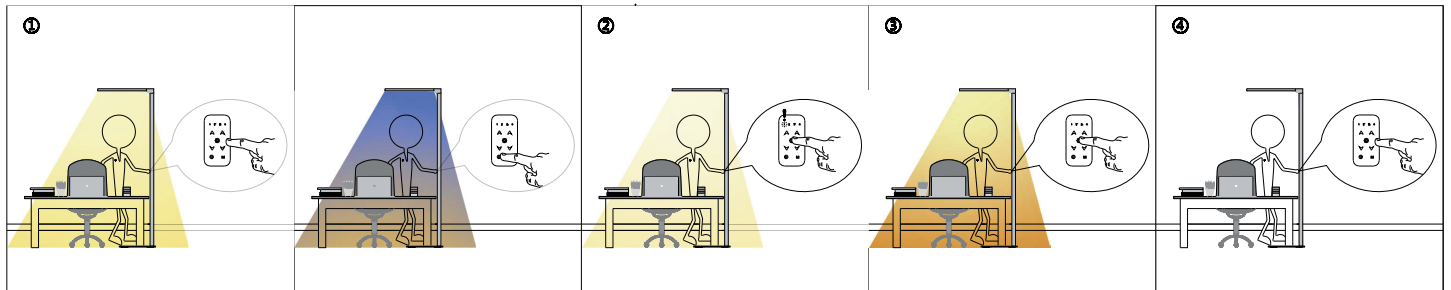

Anschalten

- ⊙ Gesamte Leuchte
- ▲ obere Leuchte
- ▼ untere Leuchte

Farbtemperaturregelung

- ⊙ Gesamte Leuchte
- ▲ obere Leuchte
- ▼ untere Leuchte

- ⊙ Gedrückt halten, um Helligkeit der gesamten Leuchte zu verändern. Wenn „1“ blinkt ist die höchste oder niedrigste Helligkeit erreicht. Um die Helligkeit in die andere Richtung zu verändern, erneut ⊙ gedrückt halten

Ausschalten

- ⊙ Gesamte Leuchte
- ▲ obere Leuchte
- ▼ untere Leuchte

MODUS 2: Bewegungs-Sensor aktiv

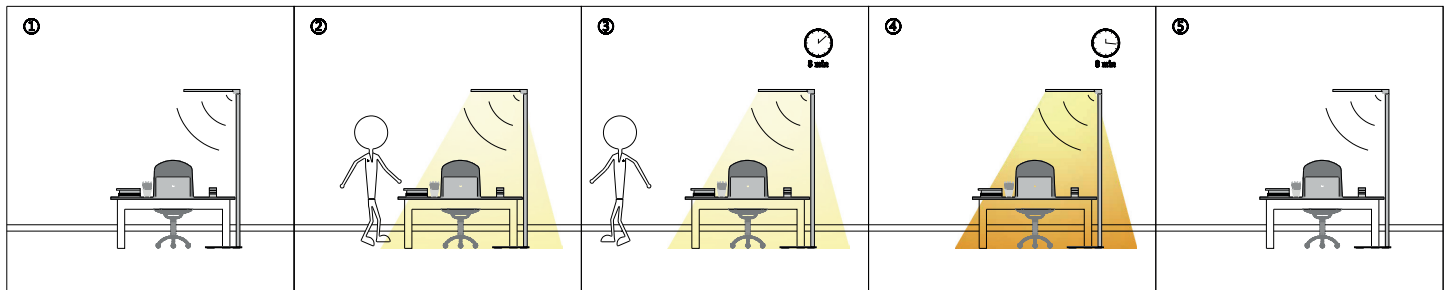

Wenn keine Bewegung erkannt wird, schaltet sich die Leuchte automatisch in Standby.

Sobald der Sensor jemanden erkannt hat, wird die Leuchte automatisch eingeschaltet.

Empfängt der Sensor 8 Minuten lang keine Bewegung, schaltet sich die Leuchte automatisch wieder in Standby.

MODE 3: Tageslicht-Sensor aktiv

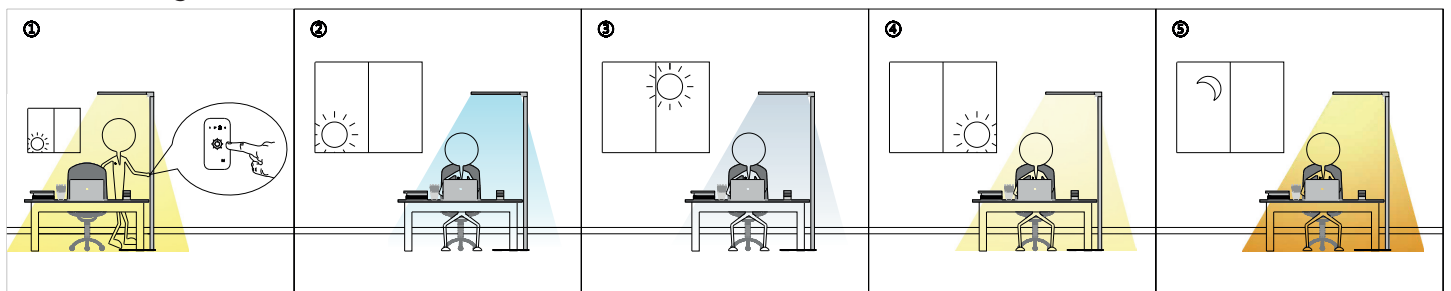

Einmal die gewünschte Helligkeit eingestellt, regelt die Leuchte die Farbtemperatur automatisch, sodass auch bei zu- und abnehmender Sonneneinstrahlung die Farbtemperatur des Lichtes sich am Schreibtisch den Tageszeiten anpasst.

Für mehr Informationen zum Tageslichtsensor besuchen Sie: www.bmb-beschlaege.de

MODE 4: Bewegungs-Sensor + Tageslicht-Sensor zusammen aktiv

UPLIGHT CLIP

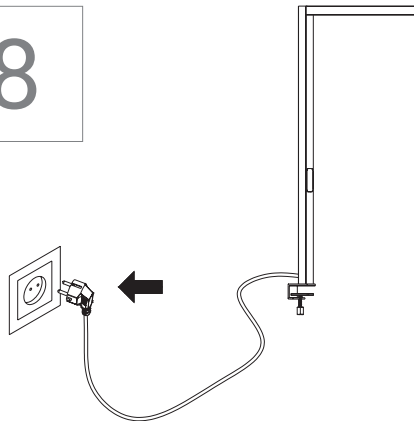
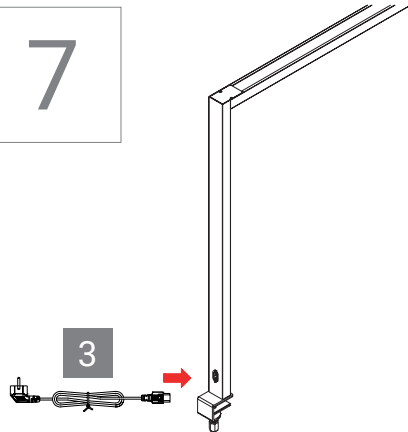
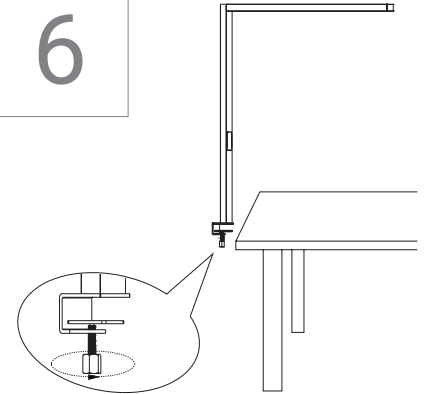
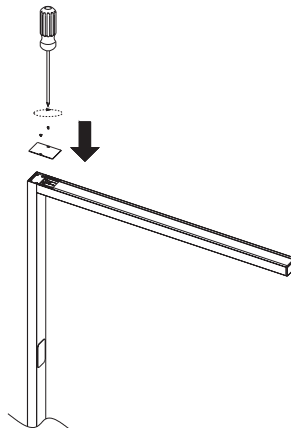
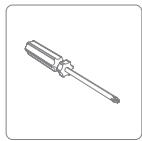
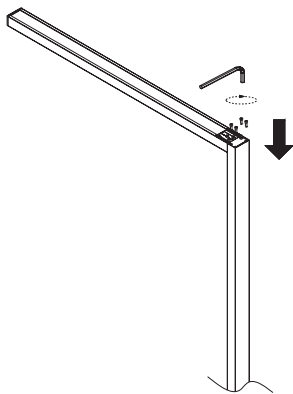
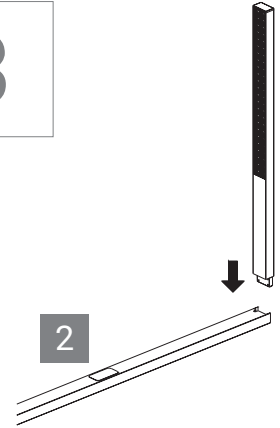
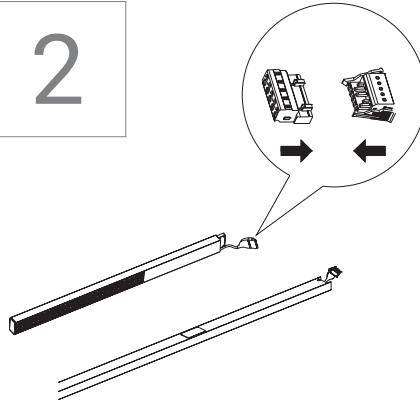
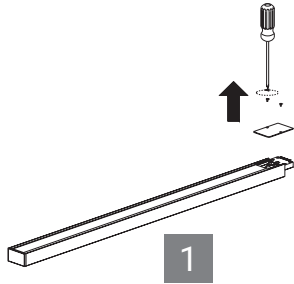
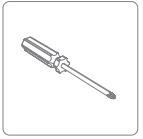
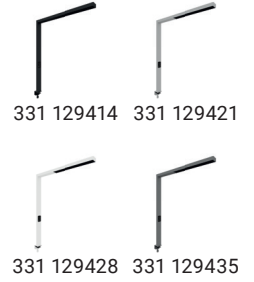
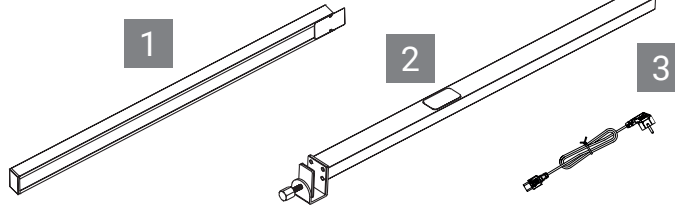
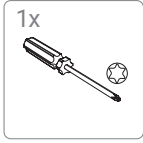
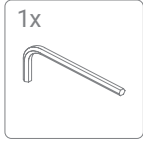
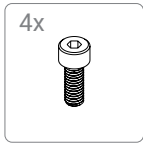

Correct disposal

The symbol of the crossed-out dustbin indicates that this electrical or electronic equipment must not be disposed of with household waste at the end of its service life, but must be taken for separate collection by the end user. Free collection points for old electrical equipment are available in your area for the return of the equipment, as well as other acceptance points for the reuse of the equipment, if applicable. You can obtain the addresses from your city or local government. Also distributors with a sales area for electrical and electronic equipment of at least 400 square meters and distributors of food with a total sales area of at least 800 square meters, which offer several times in the calendar year or permanently electrical and electronic equipment and make it available on the market, are obliged to take back free of charge old electrical and electronic equipment.

When supplying a new EEE to an end user, they must take back free of charge an old EEE of the end user of the same type that fulfills essentially the same functions as the new EEE, at the place of supply or in the immediate vicinity thereof, and, without purchasing an EEE, take back free of charge at the end user's request up to three old EEEs per type that do not exceed 25 centimeters in any external dimension, in the retail store or in the immediate vicinity thereof. If the old electrical or electronic equipment contains personal data, you are responsible for deleting this data before returning it. If this is possible without destroying the old electrical or electronic equipment, please remove old batteries or rechargeable batteries as well as old lamps from it before returning it for disposal and take them to a separate collection. For more information on the Electrical and Electronic Equipment Act, please visit www.elektrogesetz.de. (EEE Reg. No. DE: 52242201)



Technical data

Input Voltage: AC200-240V
 Input Power: 60W
 Luminous Flux: 5500 lm direct / 2300 lm indirect
 Colour Temp.: 3000 K / 4000K / 5000 K / 6000 K
 Protection Level: IP40
 Working temp.: -20C~40°C

Lighting effect: 130 LM/W
 Luminous ratio: 70% indirekt / 30% direkt
 UGR: <6
 Beam angle: indirekt: 112° / direkt: 45°
 Working lifetime: >36000 hours

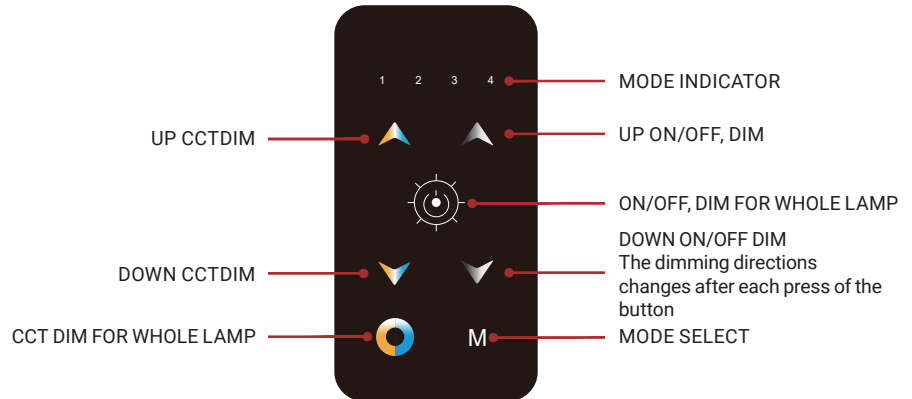
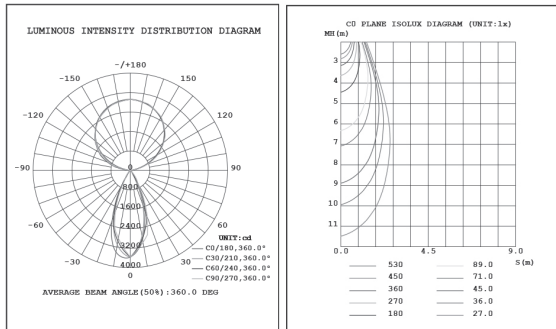

MODE 1: TOUCH PANEL (NO SENSOR)

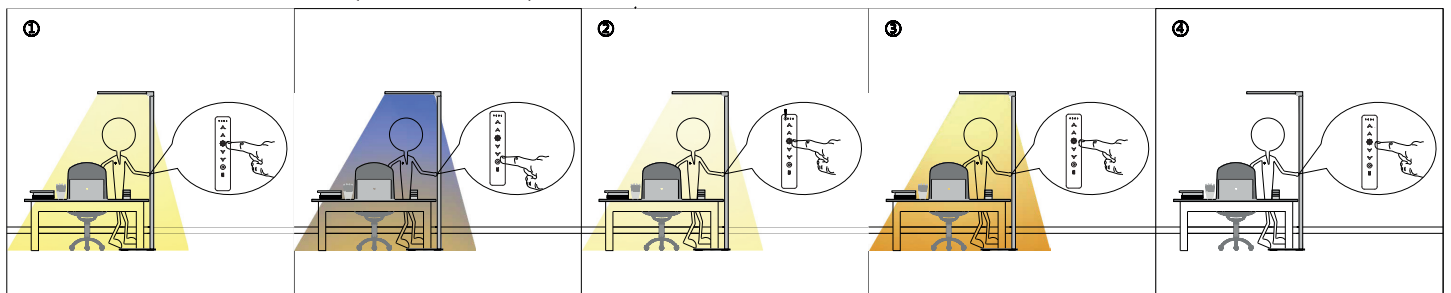

Short press

- On
- Up On
- Down On

Short press

- 3/4/5/6 CCT Select
- Up 3/4/5/6 CCT Select
- Down 3/4/5/6 CCT Select

When pressing and indicator flickering means lumen/CCT reached maximum or minimum. To change dim or CCT direction press an hold again

Short press

- Off
- Up Off
- Down Off

MODE 2: MOTION SENSOR ACTIVE

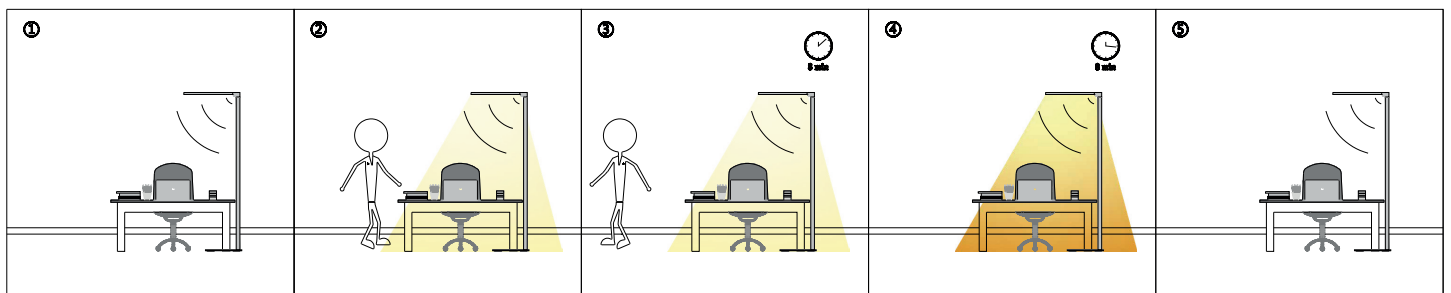

Off/Monitoring

Auto On/consant light-level on Desk

Delay time-8 min

Standby time-8 min

Auto Off/monitoring

MODE 3: DAYLIGHTSENSOR ACTIVE

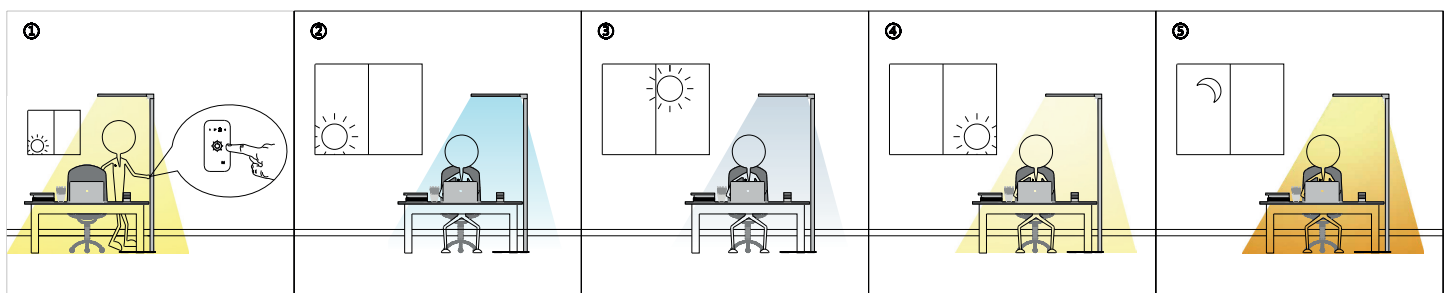

Once the desired brightness has been set, the luminaire automatically regulates the colour temperature so that even when the sunlight increases and decreases, the colour temperature of the light at the desk adjusts to the time of day. For more information on the daylight sensor visit: www.bmb-beschlaege.de

MODE 4: INTEGRATE MODE 2 & 3 (MOTIONSENSOR + DAYLIGHTSENSOR)

UPLIGHT CLIP

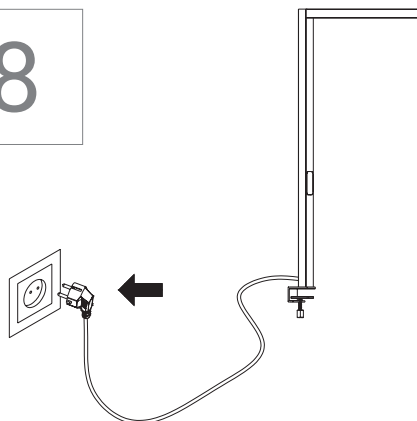
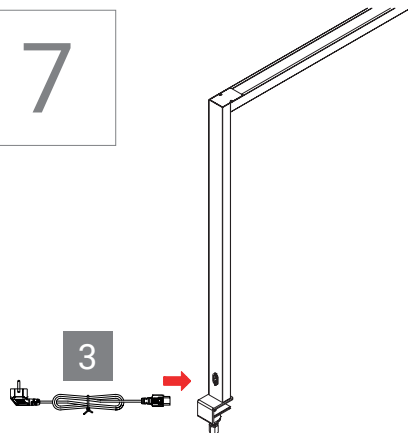
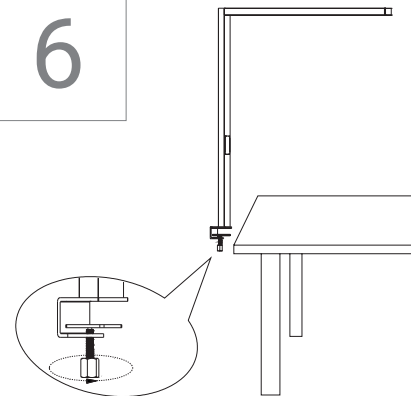
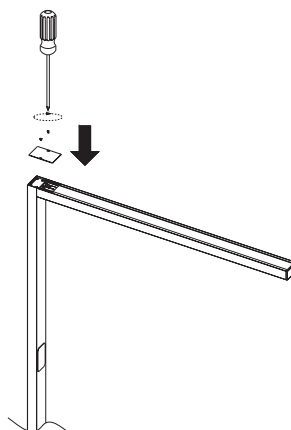
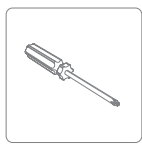
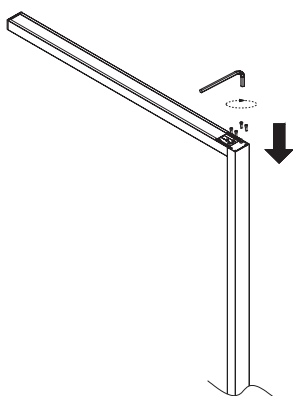
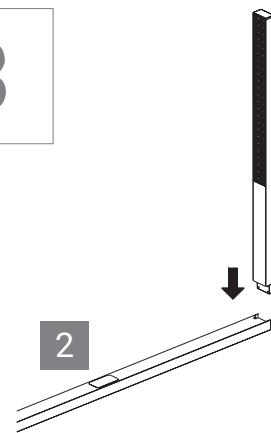
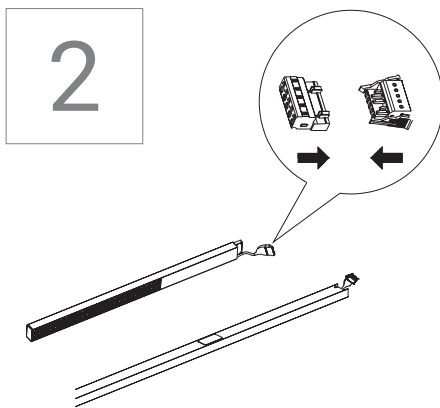
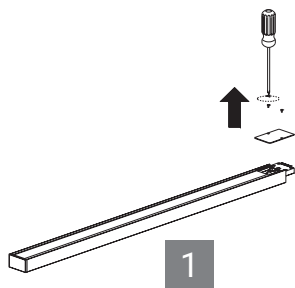
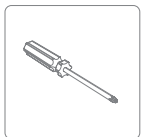
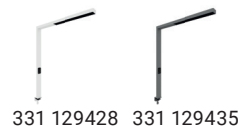
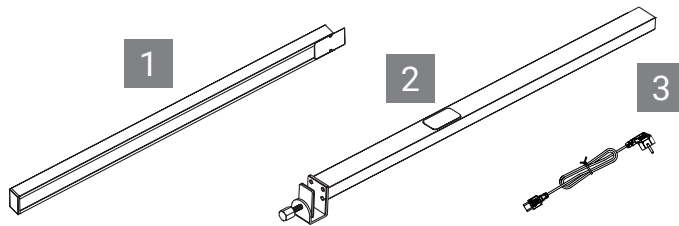
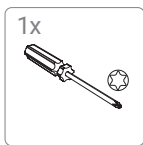
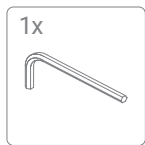
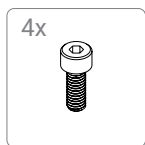

Corretto smaltimento

Ai sensi dell'art. 26 del Decreto Legislativo 14 marzo 2014, n. 49 "Attuazione della Direttiva 2012/19/UE sui rifiuti di apparecchiature elettriche ed elettroniche (RAEE)" il simbolo del cassonetto barrato riportato sull'apparecchiatura o sulla sua confezione indica che il prodotto alla fine della propria vita utile deve essere raccolto separatamente dagli altri rifiuti per permetterne un adeguato trattamento e riciclo. (WEEE-Reg.-Nr. DE: 52242201)



Dati tecnici

Tensione d'ingresso: AC200-240V
 Potenza d'ingresso: 60W
 Flusso luminoso: 5500 lm diretto / 2300 lm indiretto
 Temperatura colore: 3000 K / 4000K / 5000 K / 6000 K
 Classe di protezione: IP40
 Temp. di lavoro: -20C°~40C°

Effetto luce: 130 LM/W
 Rapporto luce: 70% indiretto / 30% diretto
 UGR: <6
 Angolo del fascio luminoso: indiretto: 112° / diretto: 45°
 Ore di operatività: >36000 ore

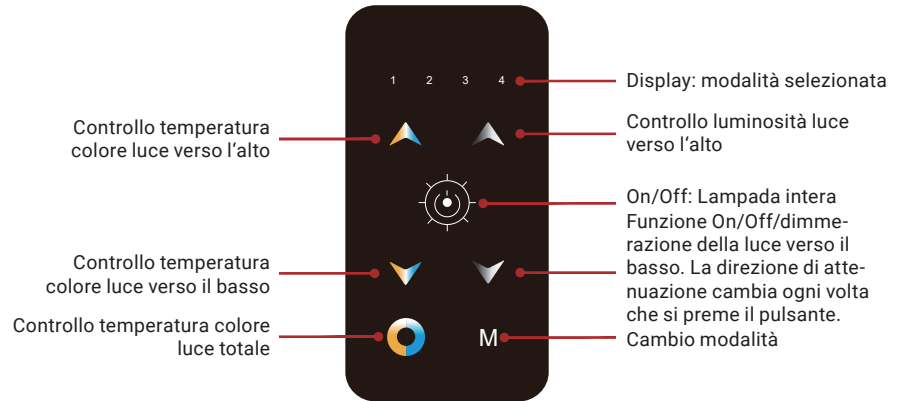
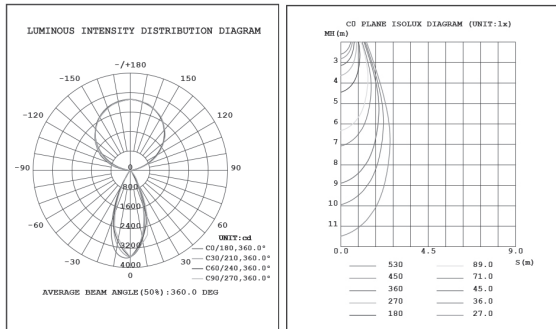

MODALITA' 1: Pannello di controllo / Manuale

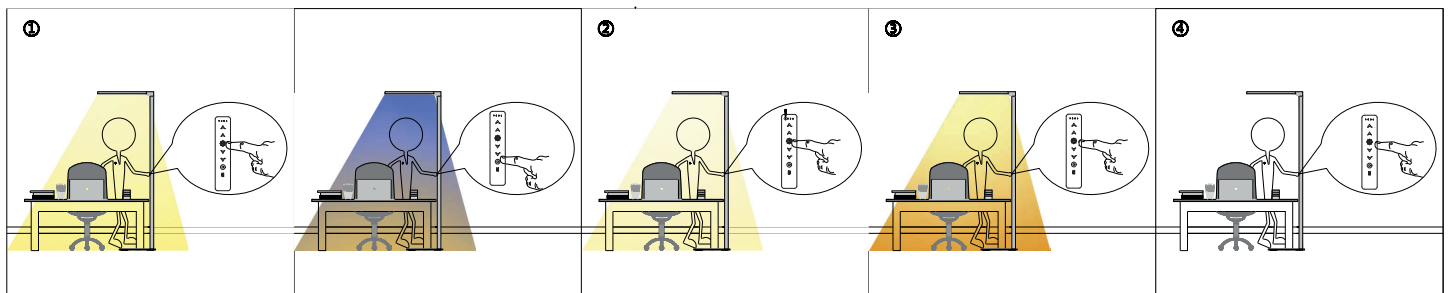

Accensione

- Lampada
- Luce superiore
- Luce inferiore

Controllo temperatura colore

- Luce totale
- Luce superiore
- Luce inferiore

- Tenere premuto per modificare la luminosità della luce totale. Se „1” lampeggia, è stata raggiunta la luminosità massima o minima. Per modificare la luminosità in un'altra direzione, tenere premuto nuovamente

Spegnimento

- Lampada
- Luce superiore
- Luce inferiore

MODALITA' 2: Sensore di movimento

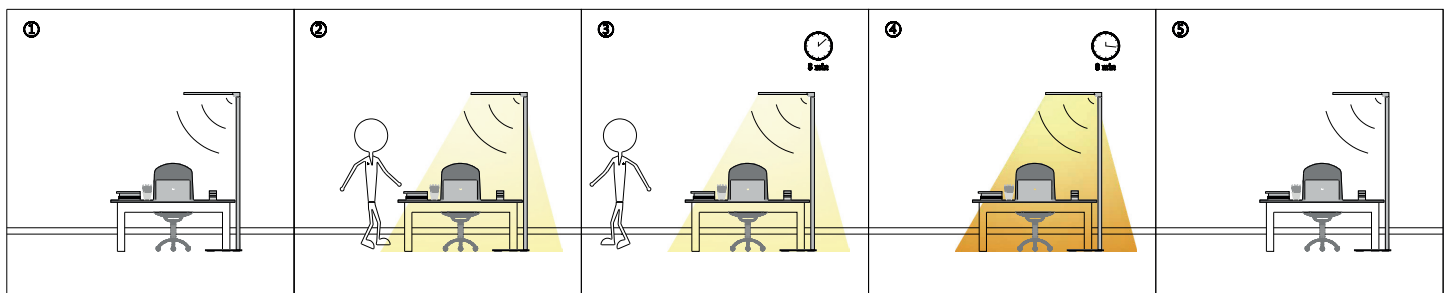

Se non viene rilevato alcun movimento, la luce passa automaticamente in standby.

Non appena il sensore rileva la presenza di qualcuno, la luce si accende automaticamente.

Se il sensore non rileva alcun movimento per 8 minuti, la luce torna automaticamente in standby.

MODALITA' 3: Sensore di luce diurna

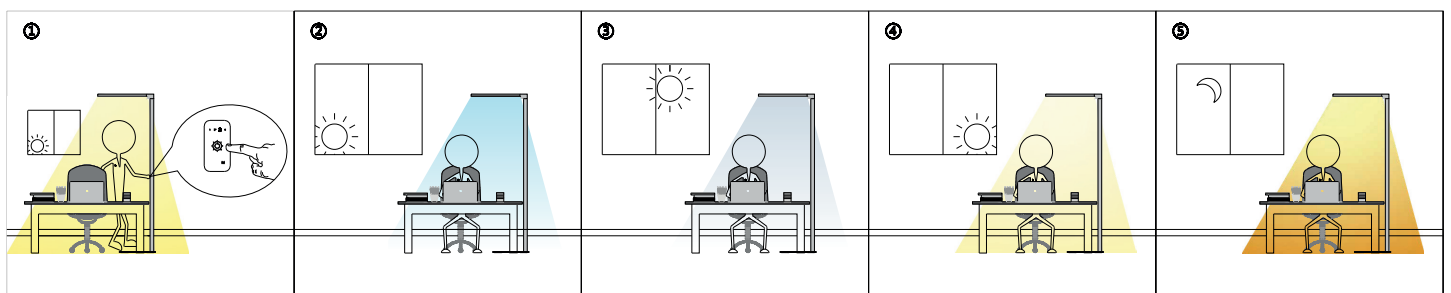

Una volta impostata la luminosità desiderata, la lampada regola automaticamente la temperatura colore in modo che si adatti all'ora del giorno anche quando i raggi solari aumentano o diminuiscono..

MODALITA' 4: Sensore di movimento + Sensore di luce diurna insieme



UPLIGHT

CLIP BF