

**Schrankovalrohr, Maße 30 x 15 x 1,0mm**  
Oval tube, dimensions: 30 x 15 x 1,0mm

**Material: Stahlrohr, nahtlos verschweißt**  
Steel tube glueless welded

**10**

**Oberfläche / Finish: Verchromt / Chrome plated**

Länge / Length	Art. No.
2000mm	403 116674
5000mm	403 116226

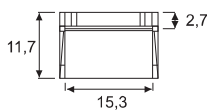
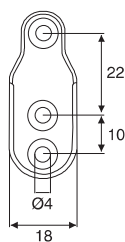
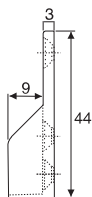
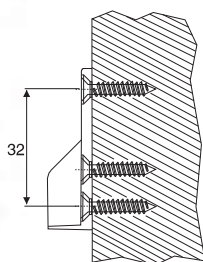

**Schrankrohrlager mit 3 Bohrlöchern**  
Tube bracket with 3 bore holes

**Material: Zamak / Zinc alloy**

**Ausführung / Finish** **Art. No.**

**Vernickelt / Nickel plated** 250 **403 116681**

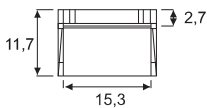
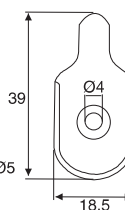
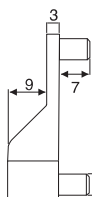
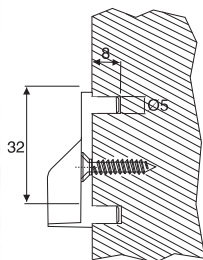

**Schrankrohrlager mit 2 Zapfen**  
Tube bracket with 2 pins

**Material: Zamak / Zinc alloy**

**Ausführung / Finish** **Art. No.**

**Vernickelt / Nickel plated** 200 **403 116191**

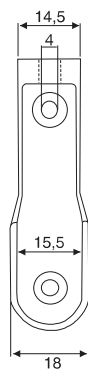
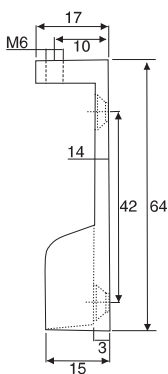
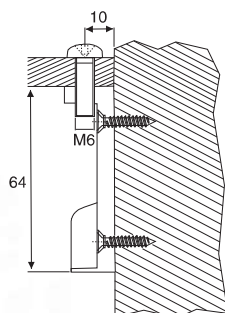

**Schrankrohrlager mit M6 Gewinde**  
Tube brackets with M6 thread

**Material: Zamak / Zinc alloy**

**100**

**Oberfläche / Finish** **Art. No.**

**Vernickelt / Nickel plated** **403 116499**

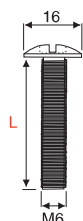

**Spezierschraube M6**  
Special screw M6

**Material: Stahl / Steel**

**100**

**L =** **Art. No.**

25mm **402 113573**