

**Solid S Ø 35mm**

Werkzeugaufnahme / Tool fitting: SW 6

Für Plattenstärke /  
For board thickness: min. 19mm

Material: Zamak / Zinc alloy

250

Oberfläche / Finish

Art. No.

Blank / Blank

402 114721

Vernickelt / Nickel plated

402 115561

Abdeckkappen für Solid S auf Anfrage

Cover caps for Solid S on request

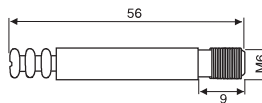
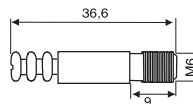

**Verbindungsbolzen für Solid S  
mit M6 Gewinde**

Connecting bolt for Solid S with M6 thread

Material: Stahl / Steel

Oberfläche: Verzinkt / Zinc plated

250

Ausführung / Type

Art. No.

Kurz / Short

402 115673

Lang / Long

402 113496

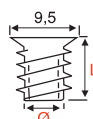
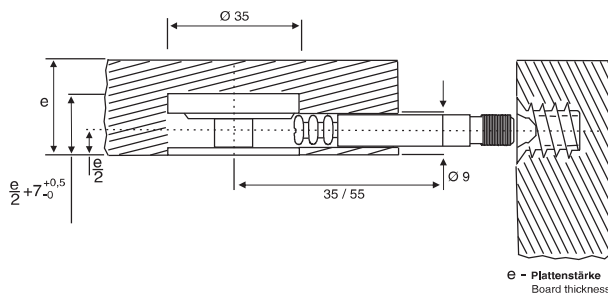

**Eindrehmuffe aus Zamak, verzinkt**

Screw-in dowel, zinc alloy, zinc plated

1000

Art. No.

L=      Ø      Gewinde / Thread

10mm    8mm      M6      402 113454

**Doppelbolzen für Solid S**

Double bolt for Solid S

**Material:** Stahl / Steel

**Oberfläche:** Verzinkt / Zinc plated

 **250**

**Ausführung / Type**

**Art. No.**

**Lang / Long**

**402 115253**

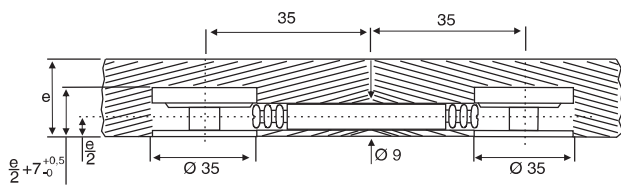
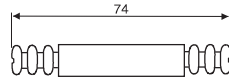

e - Plattenstärke  
Board thickness

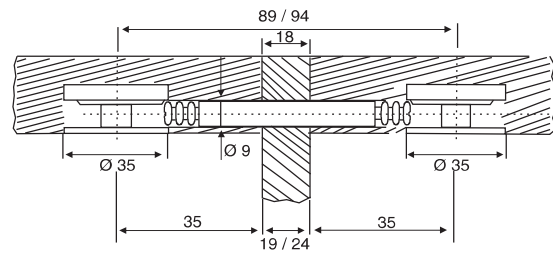

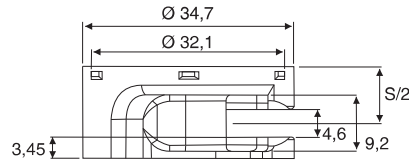

Der Schwerlastverbinder **Solid XL** ist besonders geeignet für dauerhafte Verbindungen z.B. für Massivmöbel oder als Bettbeschlag / The heavy duty connector **Solid XL** is particularly suitable for permanent connections e.g. Connections in cabinets, counters and beds

**Solid XL Ø 35mm**  
Werkzeugaufnahme / Tool fitting: **SW 6**  
Für Plattenstärke / For board thickness: **min. 19mm**  
Material: **Zamak / Zinc alloy**  
100

Oberfläche / Finish **Art. No.**  
Blank / Blank **402 113146**

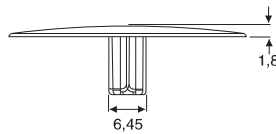
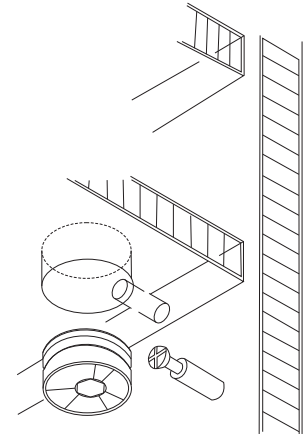
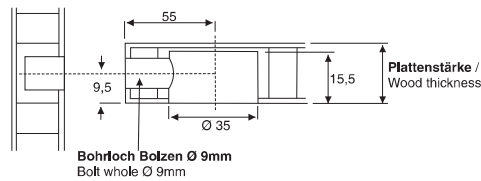

**Abdeckkappe für Solid XL, Ø 41mm**  
Covercap for Solid XL, Ø 41mm  
Material: **Kunststoff / Plastic**  
500

Oberfläche / Finish **Art. No.**  
Weiß / White **402 113608**

\* Andere Ausführungen auf Anfrage / Other finishes upon request

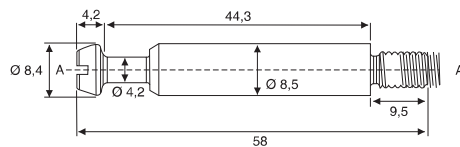

**Verbindungsbolzen für Solid XL mit M6 Gewinde**  
Connecting bolt for Solid XL with M6 thread  
Material: **Stahl / Steel**  
Oberfläche: **Verzinkt / Zinc plated**  
500

Ausführung / Type **Art. No.**  
58mm **402 114014**



**Eindrehmuffe, Stahl verzinkt, M6**  
Screw-in dowel, steel zinc plated, M6  
2000

L= **Ø** **Art. No.**  
15mm 7,5mm **402 114077**