

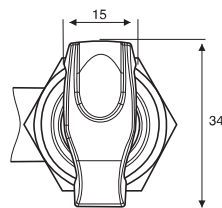

! Freilauf in geschlossener Position
 Spinning in locked position

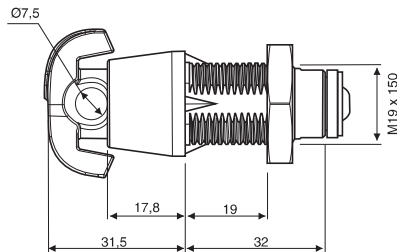

Bohrloch /
Bore hole

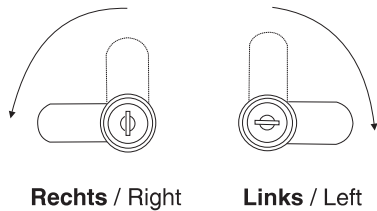
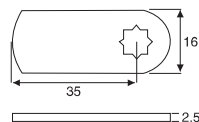
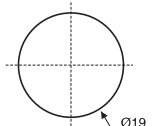

Rotor MH

Für Holztüren bis Plattenstärke 19mm, abschließbar über Hangschloss mit Bügeldurchmesser 4-6mm
 For wooden doors with board thickness up to 19mm, lockable with padlock, shackle diameter 4-6mm

Material: Zamak vernickelt /
 Zinc alloy nickel plated

10

Ausführung / Version	Art. No.
Rechts / Right	119 103864
Links / Left	119 104102

Bestehend aus / Consisting of:

- 1 Rotor MH Hebelverschluss**
1 Rotor MH hasp lock
- 1 Riegel, gerade, 35mm, Stahl verzinkt***
1 Lever, straight, 35mm, steel zinc plated*
- 1 Befestigungsschraube für den Riegel**
1 Fixing screw for lever
- 1 Sechskantmutter**
1 Hexagon nut

* Andere Riegellängen bitte separat bestellen (Seite 1.40).
 Other levers please order separately (page 1.40).



Optionales Zubehör für Rotor Hebelverschluss und Rotor M / Optional accessories for Rotor hasp lock and Rotor M:

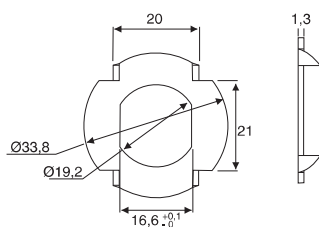

Verdrehsicherung / Anti-twist washer

Material: Stahl, verzinkt / Steel, zinc plated

Art. No.
1 119 103885

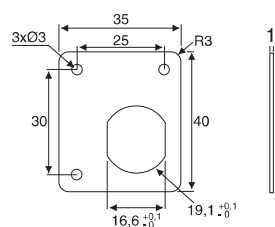

Verdrehsicherung zum Anschrauben /
 Anti-twist washer to screw-on

Material: Stahl, vernickelt /
 Steel, nickel plated

Art. No.
1 119 103948



! Freilauf in geschlossener Position
 Spinning in locked position

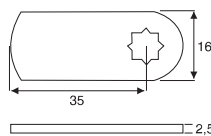
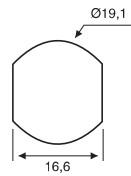
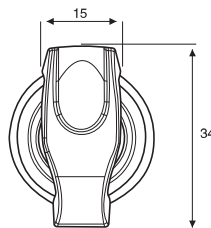
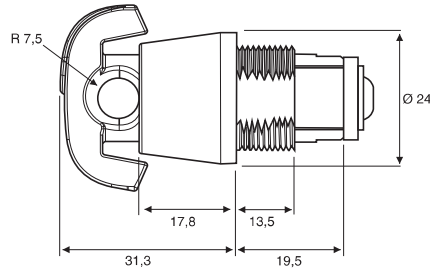
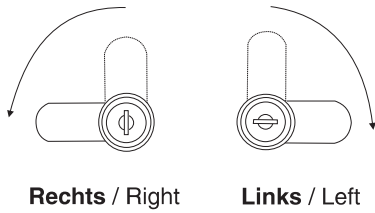

Rotor MM

Für Metallmöbel, wahlweise der Stärke 0,6-1,0mm und 3,9-4,3mm, abschließbar über Hängeschloss mit Bügeldurchmesser 4-6mm

For metal furniture of thickness 0.6-1mm and 3.9-4.3mm, lockable with padlock shackle diameter 4-6mm

Material: Zamak vernickelt / Zinc alloy nickel plated

10

Ausführung / Version	Art. No.
Rechts / Right	119 103969
Links / Left	119 103808

Bestehend aus / Consisting of:

1 Rotor MM Hebelverschluss

1 Rotor MM hasp lock

1 Riegel, gerade, 35mm, Stahl verzinkt*

1 Lever, straight, 35mm, steel zinc plated*

1 Befestigungsschraube für den Riegel

1 Fixing screw for lever

* Andere Riegellängen bitte separat bestellen (Seite 1.40).
 Other levers please order separately (Seite 1.40).

